

CONSTRUCTION BITES

Per-Fect Bite Construction Bites – 2mm & 4mm Vertical Openings

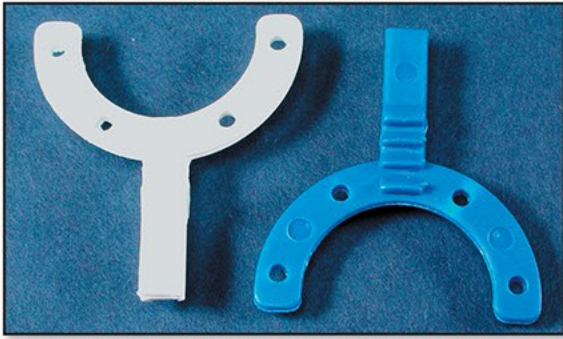

Proper Construction Bites - Less Chair Time

When prescribing a functional repositioning appliance or *any* appliance with an occlusal bite plane, it is essential to take a proper bite registration. A 3-point construction bite is the best way to capture the relationship of the maxilla to the mandible. Obtaining an accurate bite will also save you valuable chair time.

Section - I. Functional and Repositioning Bites

1. Select either the 2mm (blue) or the 4mm (white) Per-Fect Bite, depending on prescribed appliance. Utilizing the three slots on the bite fork, place the patient's upper anterior centrals in the proper slot:

Slot - #1 protruded, #2 edge-edge, #3 retruded

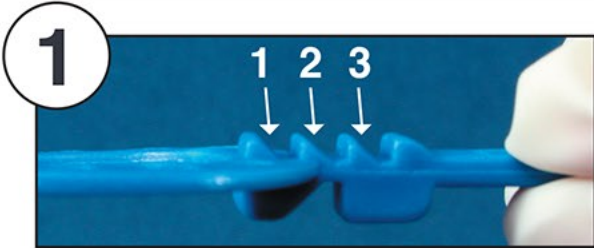

2. While holding the Per-Fect Bite in place (upper centrals in the desired notch), gently guide patient mandible into the large notch. Make sure the midlines are lined up. Have the patient practice closing into the desired position (4 to 5 times). This will help the patient locate this position at a later stage when you add the bite registration material. **NOTE: Crooked anteriors may require you to make the notch "wider" with a carbide bur so that the patient can seat completely into the bite without shifting their midline when closing.**



3. Soften a sheet of base plate wax in a hot water bath at 160°. Wrap each arm of the Per-Fect Bite with the softened wax. Then place the Per-Fect Bite back into the patient's mouth while the wax is still soft. (If necessary, resoften the wax.) When the patient is fully closed (back to the desired position), press the extruded wax from between the posterior teeth onto the buccal segment. Then cool the wax with an air syringe. **NOTE: Wax may be substituted with blue mousse or poly vinyl, if desired.**

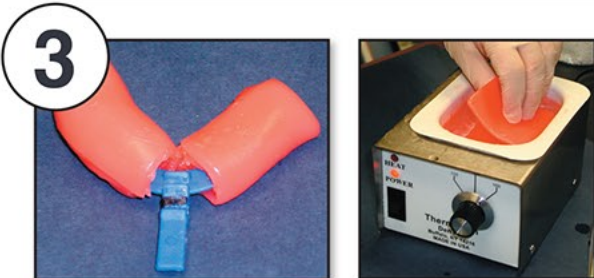

4. Remove the bite from the patient's mouth and chill it in cool water. Then recheck completed Per-Fect Bite in patient's mouth and on an accurate working model (see **Practice Bulletin: Accurate Alginate Impressions**) before sending them to the laboratory for appliance fabrication.

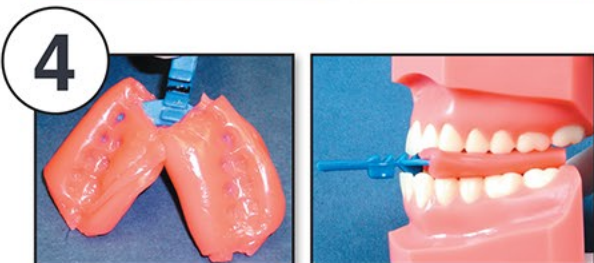

Ideal for Any Appliance Where Occlusal Coverage is Necessary

Functional Appliances • Sleep Appliances • Bruxism Splints • TMJ Splints



Order the tools necessary to take an accurate construction bite:
Call 800-423-3270 or visit www.SMLglobal.com

CONSTRUCTION BITES

Section - II. Centric and Vertical Relation Construction Bites

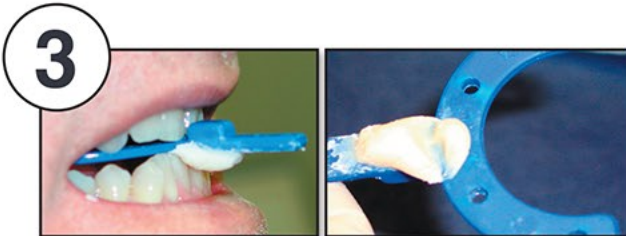
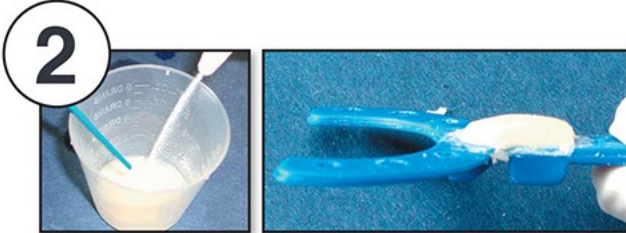
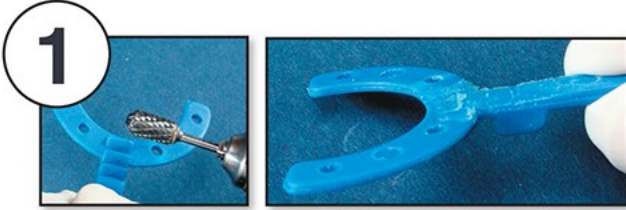

1. In order to obtain a proper centric or vertical relation bite, you must first modify the Per-Fect Bite by removing the three notches. This is easily done with a laboratory acrylic carbide bur.

2. Mix a small amount of acrylic and place a small "strip" on the area where you removed the three notches. **NOTE: To ensure acrylic bonding to the Per-Fect Bite, wet the plastic with liquid monomer first.**

3. While the acrylic is still soft, place the Per-Fect Bite in the mouth – LARGE SINGLE NOTCH UP – so that the upper centrals engage the notch. Have the patient bite into centric occlusion or centric relation so the lower anteriors index into the acrylic strip. Once this is done, dip the Per-Fect Bite into a hot water bath in order to fully cure the acrylic.

4. Follow Step 3, Section I, Functional and Repositioning Bites (opposite page).

5. Follow Step 4, Section I, Functional and Repositioning Bites (opposite page).

IMPORTANT: Make sure that when the patient is biting into the Per-Fect Bite, the midline is lined up.

NOTE: Vertical and AP position (as provided by the Per-Fect Bite) can always be modified by grinding a custom notch on the Per-Fect Bite.



330-024 Construction Bite Kit \$425.00

Includes:

- Per-Fect Bites, 2mm, pack 12 each
- Per-Fect Bites, 4mm, pack 12 each
- Hot Water Bath
- Base Plate Wax
- Lab Knife
- Carbide Barrel Bur
- Acrylic
- Dappen Dish
- Disposable Spatula



Order the tools necessary to take an accurate construction bite:
Call 800-423-3270 or visit www.SMLglobal.com